

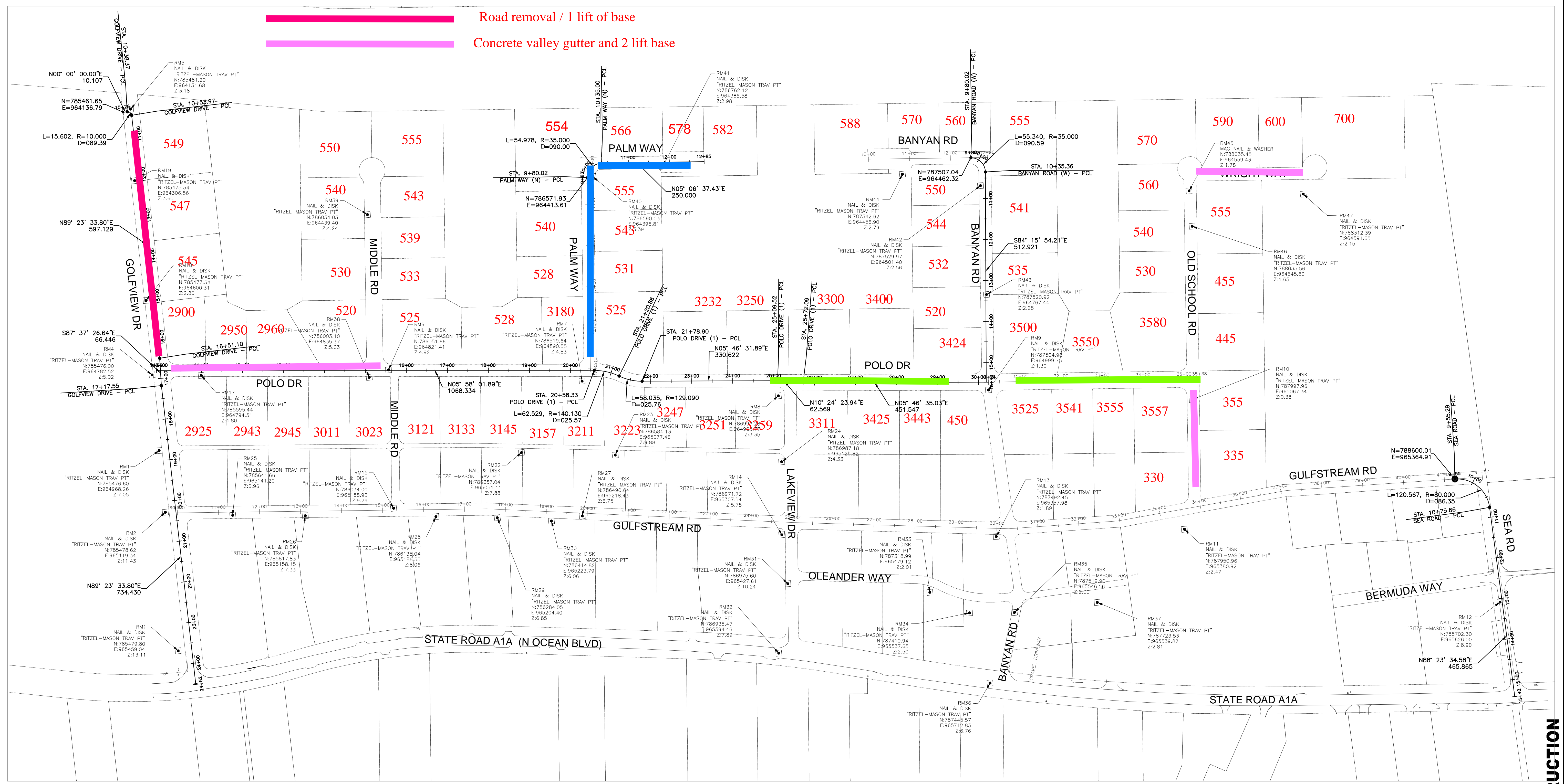

- Water line and services
- Drainage storm
- Road removal / 1 lift of base
- Concrete valley gutter and 2 lift base



Acad Version : R24.1s (LMS Tech) Date/Time : Mon, 25 Mar 2024 8:35am Current Plots/Style : ByColor/Layout Tab: G-4
 User Name : dpham Path Name : P:\GULFSTREAM\2003 - Core Area Improvements\00-Misc\CAD\00-Working\Folder\212003C_G4.dwg

CONSTRUCTION

NO.	DATE	ISSUED FOR	APRVD BY

DESIGN:	S.P.
DRAWN:	D.P./H.N.
CHECKED:	A.C.
APPROVED:	S.P.

SIRA J. PRINYAVIVATKUL, P.E.
No. 64655

BAXTER & WOODMAN
Consulting Engineers

1601 Forum Place, Suite 400, West Palm Beach, Florida 33401
Phone: 561-655-6175 • Fax: 561-655-6179
www.baxterwoodman.com EB-31795

VERIFY SCALE

1" = 100'

BAR IS ONE INCH ON FULL SIZE (22x34) ORIGINAL DRAWING. ADJUST SCALES AS NECESSARY.

ENGINEER NO.:
CLIENT
PROJECT NO.: 212003
CAD REF.:

TOWN OF GULF STREAM
CORE AREA NEIGHBORHOOD IMPROVEMENTS

HORIZONTAL CONTROL PLAN

SunshineFL.com

DATE: JANUARY 2024
SHEET: 4 of 128
DRAWING: G-4