

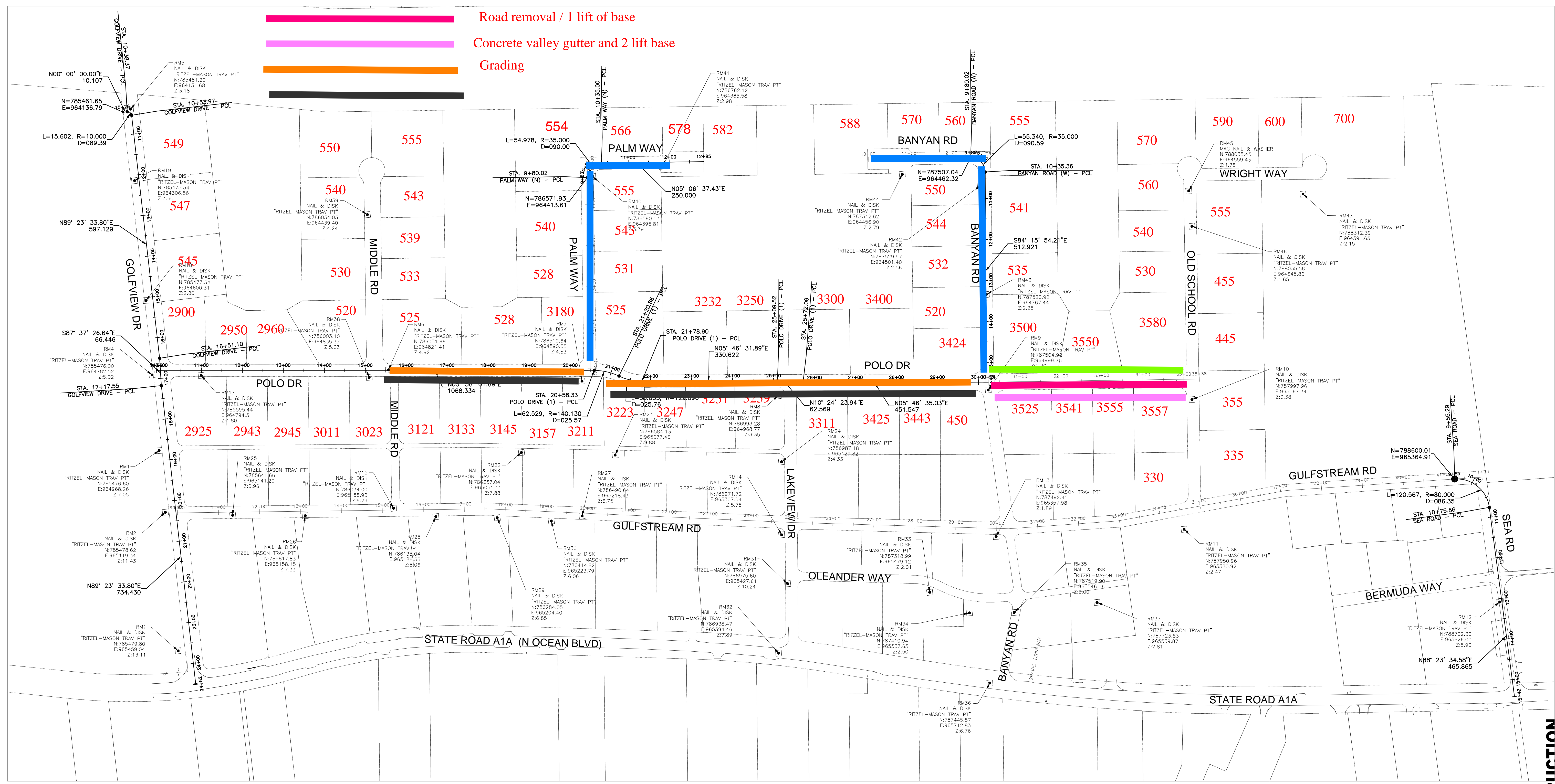

- Water line and services
- Drainage storm
- Road removal / 1 lift of base
- Concrete valley gutter and 2 lift base
- Grading



Acad Version : R24.1s (LMS Tech) Date/Time : Mon, 25 Mar 2024 8:35am Current Plots/Style : ByColor/Layout Tab: G-4
 User Name : dpham Path Name : P:\GULFSTREAM\2003 - Core Area Improvements\00-Misc\CAD\00-Working\Folder\212003C_G4.dwg

| NO. | DATE | ISSUED FOR | APRVD BY |
|-----|------|------------|----------|
| | | | |
| | | | |
| | | | |

| | |
|-----------|-----------|
| DESIGN: | S.P. |
| DRAWN: | D.P./H.N. |
| CHECKED: | A.C. |
| APPROVED: | S.P. |

BAXTER & WOODMAN
 Consulting Engineers

1601 Forum Place, Suite 400, West Palm Beach, Florida 33401
 Phone: 561-655-6175 • Fax: 561-655-6179
 www.baxterwoodman.com EB-31795

VERIFY SCALE

1" = 100'

BAR IS ONE INCH ON FULL SIZE (22x34) ORIGINAL DRAWING. ADJUST SCALES AS NECESSARY.

ENGINEER NO.:
 CLIENT
 PROJECT NO.: 212003
 CAD REF.:

TOWN OF GULF STREAM
CORE AREA NEIGHBORHOOD IMPROVEMENTS

HORIZONTAL CONTROL PLAN

DATE: JANUARY 2024
 SHEET: 4 of 128
 DRAWING: G-4

CONSTRUCTION